

TEC 30

Compact and versatile bagging

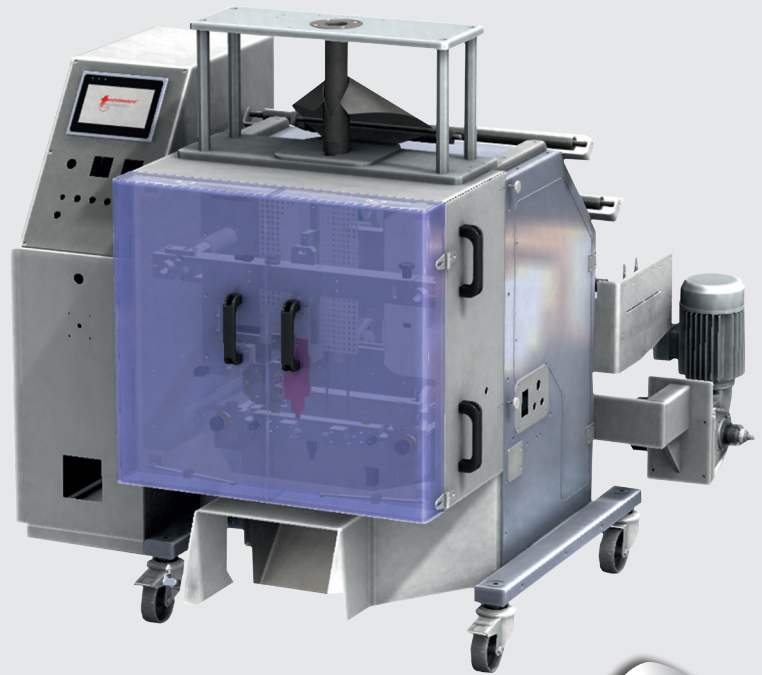

DESCRIPTION

The **TEC 30** is designed for the automatic bagging of various types of solid products, in medium or large series.

Compact and versatile, it is available in the following versions

- **Inclined**, to slow down the fall of the products
- **Vertical**, for a gain in speed.
- **Horizontal**, with an assisted introduction system to keep the orientation of the parts, ideal for fragile products.

INNOVATIVE

Human/machine touch interface oriented **Industry 4.0** to :

- *Maintain*
- *Visualize / Report*
- *Exploit / Inform*



FUNCTIONING

The **TEC 30** operates from a voltage-regulated flat film reel.

- 1** The film is conformed around a tube, called "conformer"
- 2** The parts are introduced into the conformator in manual or automatic mode
- 3** The longitudinal sealing unit makes a back seal in the middle of the bag
- 4** The cross-sealing unit seals the bottom and top of the bags simultaneously and separates them

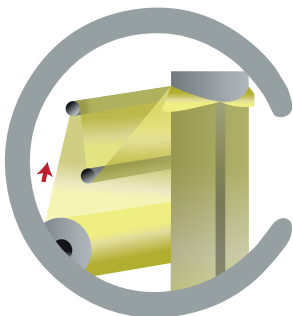

The conformator forms the bag in its width

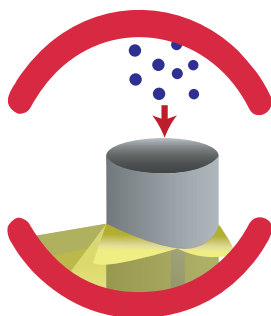

This principle avoids any risk of loss of parts

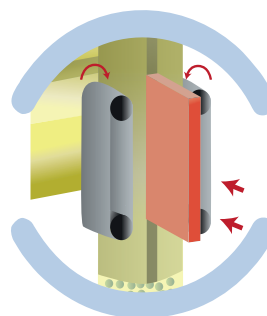

Formation of the bag in its length

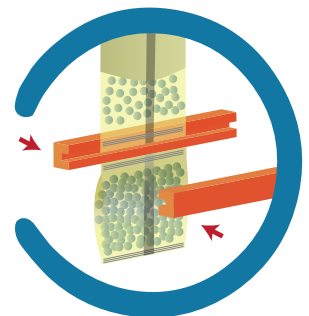

PERFORMANCE

- ⇒ Low loading height
- ⇒ Easy to move, machine mounted on wheels
- ⇒ Programmable controller
- ⇒ "BRUSHLESS" motorization
- ⇒ Touch screen and color man-machine interface
- ⇒ Production counter
- ⇒ Two welding technologies

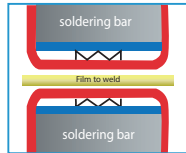

Impulse welding
Jaws equipped with welding wires

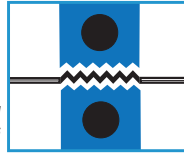

Thermal welding
Grooved and heated jaws

- ⇒ Cylindrical, oval, square or rectangular conformer
- ⇒ Motorized quick release coil holder

OPTIONS & ACCESSORIES

- ⇒ Identification by direct printing on thermal transfer film and/or application of labels
- ⇒ Heavy parts receiving flap
- ⇒ Horizontal and inclined version to protect fragile products
- ⇒ Cell for pre-printed film
- ⇒ Monobloc conformator
- ⇒ Bag vibrator to standardize the parts

Possible synchronization with other devices :

- Robot
- Conveyor belt for product supply
- Automatic counting machine
- Linear or multihead weigher
- Bag weight control
- Automatic boxing



PACKING MATERIALS

- 🌿 Biodegradable Oxo film or Biodegradable type PLA
- 🌿 Paper
- ⇒ PE film
- ⇒ Heat-sealable complex such as PP
- ⇒ Neutral or pre-printed film

GREEN SOLUTIONS



Our machines allow for 100% ecological, biosourced, recyclable and biodegradable plastics or paper sleeves.

BAG SHAPES

SYMETRICAL CUSHION BAG



OPTIONAL

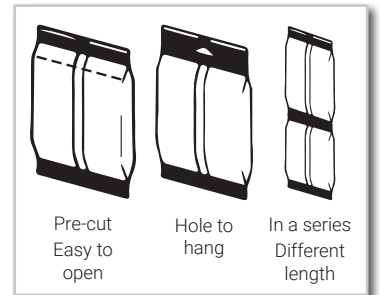

TECHNICAL CHARACTERISTICS

		TEC 30 (Impulse welding)	TEC 30 (Thermal welding)
Maximum Speed		Up to 40 bags/min <i>(Depending on film type, quality, thickness ...)</i>	
Bag weight		Up to 600 grams	Up to 1000 grams <i>(Higher weight with receiving flap)</i>
Bag size	Width	50 to 300 mm	70 to 235 mm
	Length	60 to 280 mm	
	Head opening	100 mm	
Coil size		Diameter : 320 mm	
Packing materials		Complex or thermowelding material	
		Thickness : 50 to 120µ	Thickness : 10 to 50µ
Power supply		220 V single-phase 50hz / 6 bars	
Machine weight		About 400 kg	

